

Spa Owner's Manual



call 13maax or visit maaxspa.com.au

Relax with Maax

INTRODUCTION

WELCOME TO YOUR NEW SPA

Congratulations on purchasing a spa pool from MaaX Spa. With the correct preparation and care, your new spa will provide you with many years of fun and relaxation.

This manual has been developed to provide you with the information that you need regarding the preparation, installation, care and operation of your new spa.

Please take the time to carefully read the entire manual to ensure that your spa preparations are carried out correctly. Also make sure that you familiarise yourself with the important safety instructions before using your spa.

A spa pool is an exciting addition to any home and we know you will receive many years of enjoyment from it.

ABOUT YOUR SPA

Please complete the following information about your spa pool so that we can easily assist you if service is required.

Contract Number:

Model:

Serial Number:

Inground/Portable:

Date Purchased:

Store Purchased From:

Date Delivered/Installed:

If you encounter a problem with your spa, please contact your sales consultant or your local MaaX Spa agent on 136229 to book a service.



LOCATION OF YOUR SPA

Your new spa is self-contained and in most cases portable, however there are some things you need to consider when determining where to locate your spa for maximum enjoyment and warranty protection.

OWNER'S RESPONSIBILITY

It is your responsibility, as the owner of your spa, to check with your local council or building surveyor regarding the legal requirements associated with the delivery and installation of your spa. If the spa is a portable spa you may not need a council permit for installation, although it is always good to check. However if you are using the in ground option you will also need to consult your local water corporation for the location of water, sewage pipes and easements etc in relation to installation.

POSITION

Your spa needs to be positioned so that the spa's equipment is easily accessible. The equipment is located (in most cases) at the front of the spa and will need to be accessible for service and power connection. In most cases appropriate amperage cord and plug will be provided running from the back of your spa. It is recommended that you have access to all sides allowing at least 1/2 a metre access around all 4 sides of your spa for future access if required. If a service needs to be performed, it should be easy to remove the panels so that a service technician can safely access your spa and its equipment. If access is blocked and the spa needs to be drained or physically moved in any way, it will be the owner's responsibility to make sure this is completed prior to the service being carried out. All portable spa equipment must be ventilated. Do not obstruct any vents in the cabinet.



NOTE: DO NOT leave your spa in direct sunlight for extended periods of time. Doing so may void your warranty. The spa has closed cell insulation over the shell and pipe work. If left exposed to direct sunlight the surface temperature can build up to 200°C causing damage to your spa. It is suggested that you not only have the hard cover over your spa while not in use but also have the spa in an area which is sheltered from extreme and harsh weather conditions. Leaving the spa uncovered and exposed may void your warranty on your spa and its accessories.

DRAINAGE

Ensure that the spa is not in a low or floodable position; as this could cause electrical equipment to 'short' or be dangerous to spa users. Your spa comes with a drain valve usually located in the base of the equipment compartment. Ensure that you consider access to this drain valve, and that gravity drainage onto the garden or a waste outlet is available.

VIEW, PRIVACY & ENVIRONMENT

Consider your privacy when selecting the position of your spa. Think of your surroundings during all seasons, especially protection from the wind and rain during winter. The view that you would like to enjoy from your spa is also important, along with whether your neighbours or passersby can see the spa. The climate that you live in can also determine the location of your spa. A warmer climate may require shade from the sun. A colder climate may need somewhere warm and dry to change after using the spa.

COVER

Most covers fold in half, but not all spas are square, so some covers can only fit and fold one way. Consider how you will fold the cover in half, or will there be a low overhead obstruction? Is there sufficient space to store the cover when you take it off? Are you best to have a 'cover lifter'? Which one is best for your site? What room do you need for a cover lifter? Your spa hard cover should remain on when the spa is not in use. This will help with keeping your spa water clean, cut down heating costs and protect your spa from sun or weather damage.



NOTE: all our hard covers are lock down, however please check with your local council whether they comply with safety regulations.

SAFETY

Check the surroundings where your new spa is going to be located. Particularly do not place your spa near overhead power lines, general power outlets, sharp edges, glass, thorny shrubs and other hazardous material that can affect the enjoyment of your spa, or hinder access in a dangerous manner. Check your local council regulations for fencing requirements. It is the owner's responsibility to make sure local fencing regulations are complied with.

VENTILATION

If your spa is enclosed ensure that there is adequate ventilation. Spas produce considerable amounts of moisture, which could damage walls, ceilings and fittings over time. Also keep in mind that your spa will need to be drained periodically so plan your location accordingly.

ACCESS IN & OUT OF THE SPA

Ensure that you have considered access in and out of the spa. As most spas are approx 900mm high, getting in and out is difficult. You may need steps – where will you place them?

SITE PREPARATION

Your spa has been designed to evenly support the weight of the spa, the water and the spa users, so it is essential that it sits on a solid, level, flat foundation. If the foundation is not adequate, the spa may stress and crack, thus voiding any warranty given by the manufacturer. It is the responsibility of the spa owner to provide a proper foundation. If you need help, please consult an experienced installer.

SURFACE AND SLAB REQUIREMENTS

Your new spa must be placed on a 100mm (4") thick reinforced concrete slab. Ensure that the concrete has cured for at least one week before setting the spa in place. A typical spa filled with water could weigh as much as 2500kg and if the concrete is not fully cured, it could easily crack. An uneven or cracked pad or the use of shims of any kind may cause the spa to buckle, distort and/or crack and will void the warranty on your spa.

It is recommended that the concrete slab or paving is at least 200mm bigger than the spa base size, to allow for possible future spa repositioning changes and foundation strength.

If the concrete slab is to be exceptionally larger than the spa base size, consider having the remaining area with a slight fall (5-10mm over 2m) in one direction away from the base of the spa to allow surface water to run off. Otherwise, allow for a small drain channel between the other surface area and the spa, so as to avoid other surface water getting under your new spa. See your brochure for spa dimensions.

WOOD DECKING

Wood decking is suitable provided the structure is strong enough to take the weight of the spa when full of water. An engineer's structural report is essential. If you wish to place a portable spa into a deck, it is recommended to place the spa onto a slab and build the deck AROUND the spa. The spa needs approximately 500mm access to all 4 sides of the spa for any future service work. Therefore you need to allow for access panels (trap door) in your deck.

When placing the spa into or onto a deck, it is important that it can handle the weight of the spa, the water and the people in it. Small spas will weigh around 1.5-1.7 tonnes with water and people. Large spas weigh around 2.2-4.5 tonnes. In general, you need to cater for a load of 550kg per square metre. To ensure that a deck can withstand the weight of a spa, the foot well area is the most important to reinforce, either with a vertical support post under the foot well, or more commonly, a thick timber or steel beam running horizontally under the foot well area.



NOTE: DO NOT under any circumstances, put your spa on any soft surfaces like grass, sand, crushed rock or dirt. Any surface that has a tendency to settle unevenly will put pressure and tension on the spa structure and may void the warranty.

IN GROUND INSTALLATION

If installing your spa below ground level we recommend a site visit by an experienced installer (generally at your cost) to ensure the pit is built to a sufficient size and to organise connection of your pipe work, gas and electricity to the spa. In-ground models have a very different installation procedure to portable models. We recommend you use an experienced installer to fit your spa into place.

PORTABLE HYBRIDS

In some cases a model may be supplied with electrical equipment but no cabinet surround, in most cases on a steel frame. If the spa is supplied in this fashion it is imperative that the customer makes sure that on installation, especially if it is below ground level, that all equipment is protected from water, dirt and harsh weather conditions. Having the electrical equipment exposed to these elements will void any warranty provided by the manufacturer.



ELECTRICAL INFORMATION

The electrical supply to your new spa will require a dedicated circuit with no other power appliances or sockets sharing the power.

This is important, if there are any other appliances drawing amperage from what your new spa requires, then your new spa's electrical parts may 'burn-out' in a short time. Electrical burn-out due to incorrect amperage WILL NOT be covered by warranty.

Unless you have been advised otherwise, your new spa must be permanently connected. (i.e. hard wired to the main household power supply or into a 10amp or 15amp plug). The electrical supply must be installed by a qualified licensed electrician to comply with all regulations and standards specified by the electrical authority.

Ensure that your electrician installs at the main house supply:

- A suitable rated RCD (Residual Current Device)
- A suitable rated circuit isolating switch that is no closer than 2m from the spa, which is accessible for the home owner for turning the spa off and on.
- A weather proof outdoor connection point.

Your electrician will want to know how many amps your new spa draws.

ELECTRICAL REQUIREMENTS FOR YOUR SPA

Spa's requiring 10amp electrical connection must have;

- 10amp power socket NO LESS than 2 metres away from the spa.
- 10amp power socket MUST BE installed by a qualified electrician.
- PLEASE NOTE No power points are to be within a 2 metre parameter of the spa.

Spa's requiring 15amp electrical connection must have;

- 15amp power socket NO LESS than 2 metres away from the spa.
- 15amp power socket MUST BE installed by a qualified electrician.
- PLEASE NOTE No power points are to be within a 2 metre parameter of the spa.

Spa's requiring 32amp electrical connection must have;

- Single phase, dedicated, hard wired, 32amp circuit.
- A circuit breaker and RCD in your power box.
- At least enough cable in flexible conduit to reach your spa pool control box.
- An isolating switch close to the spa.
- A qualified electrician to do the installation and deliver a certificate of compliance.
- PLEASE NOTE No power points are to be within a 2 metre parameter of the spa.

Spa's requiring 40amp electrical connection must have;

- Single phase, dedicated, hard wired, 40amp circuit.
- A circuit breaker and RCD in your power box.
- At least enough cable in flexible conduit to reach your spa pool control box.
- An isolating switch close to the spa.
- A qualified electrician to do the installation and deliver a certificate of compliance.
- PLEASE NOTE No power points are to be within a 2 metre parameter of the spa.



NOTE: Only a qualified electrician can legally install and connect your electrical requirements for your spa. If you have any questions in regards to the electrical connections please see your local spa specialist. Please see your spa specialist in regards to high current and three phase installation procedures.

IMPORTANT OWNER'S INFORMATION

It is essential to familiarise yourself with general spa pool safety and water treatment procedures. As a spa pool owner, it is your responsibility to ensure spa pool safety rules are adhered to.

RISK OF ELECTRIC SHOCK

As with all electrical appliances there is a risk of electrocution. The engine room within the cabinet, houses the control unit that operates the spa. The door enclosing the unit should always remain shut. If water happens to enter the engine room, turn the spa off at the power outlet and make sure all the components are dry before attempting to power the spa back up.

TEMPERATURE

Keep your spa water temperature no higher than 40°C. Higher water temperatures can cause strain on the cardiovascular system. If the water temperature is higher than 40°C, get out of the spa and contact the manufacturer as soon as possible. It is recommended that the water temperature be no higher than body temperature i.e. 37.5°C

MEDICAL CONDITIONS

People with diabetes, high blood pressure, heart disease or other cardiovascular conditions should consult their physician before using a spa.

MINIMISING THE RISKS

To reduce the risk of contaminating spa water and minimise health risks, shower with soap and water prior to using the spa. People with open sores or any type of infection should not use the spa. Hot water is an ideal environment for spreading infection, especially if sanitiser levels are not properly maintained.

SOAK AND COOL TIME

Limit spa use to no more than 15-20 minutes at a time. Some spa pools are equipped with a cooling seat. When you feel you are getting too hot, sit on the cooling seat and allow your body to cool. When you feel comfortable you may submerge yourself back into the spa pool. Sitting in the spa with your head above the water level will dramatically decrease the time it takes to cool down.

Hyperthermia may be fatal. Do not expose your body to prolonged exposure in water above normal body temperature.

ALCOHOL USE AND MEDICATION

The consumption of alcohol in and around the spa pool is a hazardous practice. Never use glass drinking vessels near the spa pool. Alcohol can cause drowsiness and lead to drowning. Any person taking medication should consult their physician before entering the spa pool.

CHILD SAFETY

Children should not be permitted to use the spa without adult supervision.

PREGNANCY

Women who are pregnant should consult their physician before using a spa.

PREVENTING SLIPS

Always take care when entering and exiting a spa due to slippery, uneven surfaces. Handrails and non-slip surfaces will help to minimise the risk of slipping and falling. In some cases steps may be needed to make entering the spa easier.

ELECTRICAL APPLIANCES

Never have any electrical devices within 2 metres of the spa.

WEATHER CONDITIONS

Do not operate or soak in a spa during severe weather conditions i.e. thunderstorms, cyclones or electrical storms.

VENTILATION

If the spa pool is not sufficiently ventilated some people may experience throat irritations. Make sure that the spa pool is properly ventilated if you are installing it in an enclosed area.

CHEMICALS

Spa chemicals are necessary to control bacteria, prevent infection and maximise the life of your spa and its equipment. However, in concentrated form these chemicals, like other household chemicals, can be hazardous.

Always handle and use them with care. Refer to the product's label for safety and handling information. A more in-depth explanation on how to use chemicals in your spa can be found in the Chemical Management section.

SPA MAINTENANCE

Owning a spa is fun, relaxing and therapeutic, but more importantly we must look after our investment to keep it healthy and economical, thus avoiding unnecessary premature repair costs.

Detailed below is a simple step-by-step procedure to follow.

FILLING YOUR SPA

Before filling your spa, please tighten the barrel unions. The barrel unions are two big plumbing nuts located at the wet end of each pump and heater element. These can sometimes come loose during transportation.

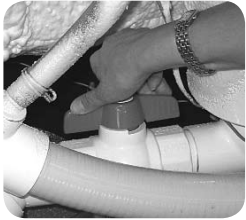

Shut off valve



Jets

Check that the shut off valves are all in the open position lengthways along the piping or pulled up (for inverted type).

Check that all jets are in the open position. Turn anti-clockwise to turn your jets on.

When re-filling your spa, do so through the filter. (Tip!! When draining and re-filling your spa the filters should be cleaned, along with the spa surface, jets and behind the headrests. The latter three can be cleaned with methylated spirits.)

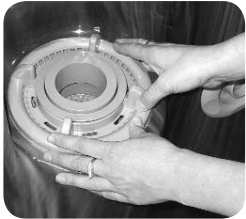

Filter box



Fill your spa with water. This should be done through the filter to stop air locks forming. Heat to desired temperature then test water balance and adjust pH, total alkalinity and chlorine. (Refer to Water Quality & Maintenance section).

Please see your local spa specialist for suggested water treatments.

DRAINING YOUR SPA

If you use your spa say once or twice a week, the need to drain your spa will be less frequent than a spa owner who uses their spa three or more times a week. Therefore, it would be recommended that a spa be drained at least every 4 - 5 months. Your drainage valve is positioned at the front on the inside of the cabinet. This has a garden hose connection at the end. Simply connect your hose, turn the valve anti-clockwise and your spa will begin draining.



Drain



NOTE: Be sure the power to your spa is turned off before draining. Damage to equipment due to dry running is not covered under warranty.

SANITISING YOUR SPA

Proper sanitisation of your spa is important. Ensure you maintain residual sanitiser levels to product recommendations (refer to instructions on product). Use test strips to measure your sanitiser levels.

SPA MAINTENANCE CHECKLIST

SHOCK DOSING YOUR SPA BY ADDING CHLORINE CONCENTRATE

Removing a build up of body fats and oils is important not only for health reasons but also for maintaining an inviting sparkling clear spa.

Remove cover from spa and leave off for a minimum of 1 hour. With pump and filter running, add 40gms of Chlorine Concentrate per 1500 litre spa or 25gms per 1000 litre spa. This should be added at least once a week or after heavy use. Continue to run spa pump/s for at least one hour as per step one. (Refer to Water Quality & Maintenance section.)

CLEANING YOUR FILTERS

You should clean your filters regularly. Once a week you should remove your filters and hose any debris out of them with a high pressure hose. Once a month you should soak your filters in a cartridge filter cleaning solution and then hose off with a high pressure hose.



Open filter box



Remove & soak filter



Hose off cleaning solution



NOTE: When you remove your filters, ALWAYS ensure that the power to your spa is off before doing so. If you leave your power on and anything is drawn into your pump or heater, causing either to fail the fault will not be covered under warranty.

WHEN YOUR SPA IS NOT IN USE

If you are going away for a period longer than 2 months, it is recommended that you turn your spa off and empty it. It is important to remember to leave the cover on even while empty to protect the shell. If you are going away for a few days or weeks, do not turn your spa off completely. Turn the temperature down to 15 degrees, so that the filtration cycles are still functioning but the spa doesn't heat.



Spa cover



NOTE: At no time should you leave your spa in direct sunlight for prolonged periods of time. Please make sure you place the cover back onto the spa after every use or chemical application. Failing to cover your spa from direct sunlight may damage your spa shell and void all warranty.

IMPORTANT TIPS TO REMEMBER

IF WATER QUALITY IS POOR:

Clean filters, test and balance water and run spa for an hour.

EVERY TIME YOU EMPTY YOUR SPA:

Remove and clean the jets if stiff or scratchy. If jets do not turn or spin, this is due to chemical build up and/or sand/grit behind them.

FROM TIME TO TIME:

Protect your cabinet with oil when showing signs of weathering. Wipe or paint on. Rub in/off excess.



JET MAINTENANCE

ADJUSTING YOUR WATER FLOW

To adjust the water flow to fully open position on the Exhilarator and Excess spa jets, simply rotate the jet face in an anti-clockwise direction until you come to a stop. Your spa jet is now operating at full pressure. To reduce the flow, simply rotate the jet face in a clockwise direction. When the jet is in the closed position you will still feel a small amount of flow from the jet. This is perfectly normal. The jets have been designed to allow a small amount of water through to protect the pump, in case all the jets were turned to the off position.

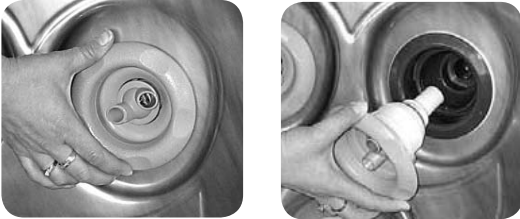

Removing spa jets

REMOVING YOUR SPA JETS

To remove the spa jets, simply turn the spa jet in an anti-clockwise direction to the fully open position. Then turn it a little more and pull the jet towards you. Your jet will now come out of the jet body.

REPLACING YOUR SPA JETS

Place the jet face back into the jet body and with the palm of your hand rotate it in an anti-clockwise direction. You will feel the jet click into place. Your jet is now fully operational.

INTERCHANGING YOUR SPA JETS

Yes you can. Simply follow the remove and replace steps to interchange your jet faces to another section of your spa.

ALTERING THE NOZZLE ON THE THERAPY JET

With the palm of your hand, rotate the jet face in an anti-clockwise direction (about a 1/4 of a turn). This will loosen the jet face enough so that you can adjust the jet nozzle to its new position. Once you have located the nozzle to its new position, simply tighten the jet face by rotating the jet face in a clockwise direction (about a 1/4 of a turn).

MAINTENANCE OF YOUR SPA JETS

Your spa jets should require very little maintenance. However, you should occasionally remove the jets, rinse and clean in soapy water, then thoroughly rinse before placing them back in your spa. Maintain your water balance in accordance with the manufacturer's specification to enjoy many years of trouble free operation.



NOTE: All jet removals and replacements should be done when the pump or pumps are switched off.

THESE RECOMMENDATIONS ARE A GUIDELINE ONLY.



WATER QUALITY & MAINTENANCE WITH OZONE

Please note these instructions are just a guide to maintaining your spa's water quality. As there are a number of different products to clean your spa and the water capacities can vary, please see your local spa specialist for exact quantities of product to use.



NOTE: You should never use pool grade chemicals in your spa. Any damage to equipment caused by using pool grade chemicals will not be covered under warranty. You should have your water tested professionally at least once a month on top of testing weekly yourself! Whenever adding chemicals to your spa remember that it will take time for the chemicals to mix into the water. Don't get hasty, leave it to mix in for 20-30 minutes.

FRESH FILLING YOUR SPA WITH OZONE

Fill your spa. Once your spa is filled, turn the spa on and set the temperature at your desired level.



Testing water

Important – When filling your spa remove filter/s and place hose in filter hole and turn the hose to fill the spa to required level this will help prevent air blockages.

INITIAL START UP

- Add pH and alkalinity balancer, run with jets (no blower) for 2 hours.
- Then add Lithium Hypochlorite or non chlorine shock oxidizer, run jets (no blower) for 30 minutes.
- Place the Nature² Cartridge (natural mineral purifier) into the filter basket or insert down the centre of the filter cartridge. This should last 4-6 months.
- After the 3rd day of initial start up remove filter/s and use a high pressure hose to remove excessive build up on the filter/s cartridge/s. Repeat the process in another 3 days time. This is to clear the initial fresh fill dirt and particles from the spa.

WEEKLY & MONTHLY MAINTENANCE

- Once per week remove filter/s and clean with fresh water from a high pressure hose.
- Once per month soak the filter/s in filter cleaner and continue to clean with a high pressure hose weekly.
- Check pH & alkalinity levels with your test strips and if pH and alkalinity is low add a small amount of pH and alkalinity balancer and run for 20 minutes with the cover off to increase or decrease required levels.
- Once per week add Lithium Hypochlorite and run pump for 20 minutes.
- Don't forget to add a little non chlorine shock oxidiser or Lithium Hypochlorite after every time you use the spa. This will help with keeping your spa clean and fresh. Leave the spa running with the cover open for 30 minutes.



NOTE: An Ozone spa is not dependent on high amounts of Lithium Hypochlorite (Chlorine), however it is suggested in doses recommended.

Please refer to your local spa specialist for the best water maintenance in your local area.



WATER QUALITY & MAINTENANCE WITH BROMINE

Please note these instructions are just a guide to maintaining your spa's water quality. As there are a number of different products to clean your spa and the water capacities can vary, please see your local spa specialist for exact quantities of product to use.



NOTE: You should never use pool grade chemicals in your spa. Any damage to equipment caused by using pool grade chemicals will not be covered under warranty. You should have your water tested professionally at least once a month on top of testing weekly yourself! Whenever adding chemicals to your spa remember that it will take time for the chemicals to mix into the water. Don't get hasty, leave it to mix in for 20-30 minutes.

FRESH FILLING YOUR SPA WITH BROMINE

Fill your spa. Once your spa is filled, turn the spa on and set the temperature at your desired level. Important – When filling your spa remove filter/s and place hose in filter hole and turn the hose to fill the spa to required level. (This will help prevent air blockages).

INITIAL START UP

- Add pH and alkalinity balancer, run with jets (no blower) for 2 hours.
- Add the Bromine to your floater or bromine dispenser.
- Add Lithium Hypochlorite or non chlorine shock oxidizer, run jets (no blower) for 30 minutes.
- After the 3rd day of initial start up remove filter/s and use a high pressure hose to remove excessive build up on the filter/s cartridge/s. Repeat the process in another 3 days time. This is to clear the initial fresh fill dirt and particles from the spa.

WEEKLY & MONTHLY MAINTENANCE

- Once per week remove filter/s and clean with fresh water from a high pressure hose.
- Once per month soak the filter/s in filter cleaner and continue to clean with a high pressure hose weekly.
- Check pH and alkalinity levels with your test strips and if pH and alkalinity is low add a small amount of pH and alkalinity balancer and run for 20 minutes with the cover off to increase or decrease required levels.
- Once per week add Lithium Hypochlorite and run pump for 20 minutes.
- Don't forget to add a little non chlorine shock oxidiser or Lithium Hypochlorite after every time you use the spa. This will help with keeping your spa clean and fresh. Leave the spa running with the cover open for 30 minutes.

IMPORTANT

- After initial 3 days of use remove filters and hose to remove excessive build up. Repeat process in 3 days.
- Then once per week remove filters and hose out with fresh water.
- Once per month soak with Filter Brite whilst continuing to hose out weekly.
- Add more Bromine tablets to floating dispenser if Bromine levels are too low.



HELPFUL HINTS



Diverter valve



ZONE SELECTORS

Some spas are fitted with zone selectors. Zone selectors are for transferring water from one area to another. If you find them tight or stiff, turn the spa off at the power point, lift off the handle, hold the outside of the selector and turn anti-clockwise. Remove centre gate out of housing, wipe any sand or dirt from the gate, wipe down inside housing. Sand scratches with light sand paper and put back together.



Air control



AIR CONTROLS

Air controls affect the pressure of your jets by adding air. You may have more than one air control on your spa, each of which will be associated to a certain group of jets. By opening an air control when the pump is on air will be drawn into the water flow. When an air control is turned anti-clockwise it is on and when turned clockwise it is off. For best heating efficiency turn air controls to the off position when the spa is not in use.



Airlock



AIRLOCKS

If you have emptied and refilled your spa and the pump comes on but there is no water movement in your spa, the spa is probably suffering from an air lock. To get the air out of your pump, turn the spa off and find the filtration pump, which is situated inside the spa cabinet. Locate the pipe which goes into the top of the pump. This has a large nut, which is called the barrel union. Undo anti-clockwise until you hear the air escape. When the water comes out, re-tighten. This should fix the airlock. Sometimes you have to start the pump again to remove the air. To prevent this from happening, always fill the spa through the filter box.



Touchpad

TOUCHPAD

If you are experiencing problems with your spa a message ie. "FLO" will appear on your Topside Control. Please refer to the Quick Reference Guide provided with your spa to problem solve. If you have misplaced your Quick Reference Guide please go to www.maaxspa.com.au. If you need further assistance please contact your local dealer on 136229.



Headrests



HEADRESTS

If your headrests are dirty clean them with a vinyl cleaner. If your headrests are becoming discoloured and you have Ozone fitted, this is a natural oxidising process from the ozone gas and this is not covered under warranty. This also can be caused by over chlorination. However, it is recommended that you remove the pillows from the spa after every use. Be careful when removing/refitting pillows. If broken, they are not covered by warranty.



Timber Cabinet

TIMBER CABINET

To rejuvenate your timber cabinet, use exterior timber treatment available from your local spa specialist. This procedure is recommended twice a year.



Spa Cover

SPA COVER

To clean your spa cover, simply use warm soapy water and hose off, being careful not to get soapy water into the spa. If you want to prolong the life of your hardcover and preserve its finish, use a Bio Guard product called 'Cover Renew' or a similar product. The spa has small holes in the underside. These holes are for condensation, which builds up inside the cover. Do not hold the cover by the seals (between the two halves). They are not handles, and will break. The hardcover is not designed for sitting, jumping or lying on.



IMPORTANT: Please make sure you place the cover back onto the spa after every use or chemical application. At no time should you leave your spa in direct sunlight for prolonged periods of time without the cover on as this may damage your spa shell and void all warranty.

SCUM LINES

If you are experiencing scum lines around your spa, you can do one of two things. Either get a plastic scourer (so as not to damage the spa) and run it around the waterline of your spa, or turn power off and drain spa completely. Once drained, wipe the whole shell with methylated spirits. Refill to correct level before turning spa on.

TROUBLESHOOTING

For specifics on Control and Heater Packs, please refer to Quick Reference Guides included in your Information Kit.

If you have a problem you cannot solve, please report it directly to your local spa specialist or where you purchased your spa (otherwise your warranty could be voided).



IMPORTANT: Please fill in your enclosed warranty form and return to the manufacturer within 15 days of delivery to ensure your full warranty is valid.



NOTES

Lined area for notes, consisting of multiple horizontal dotted lines.



call 13maax or visit maaxspa.com.au

Relax with Maax